

DCS-208FR3

Fire-Rated In-Wall Subwoofer

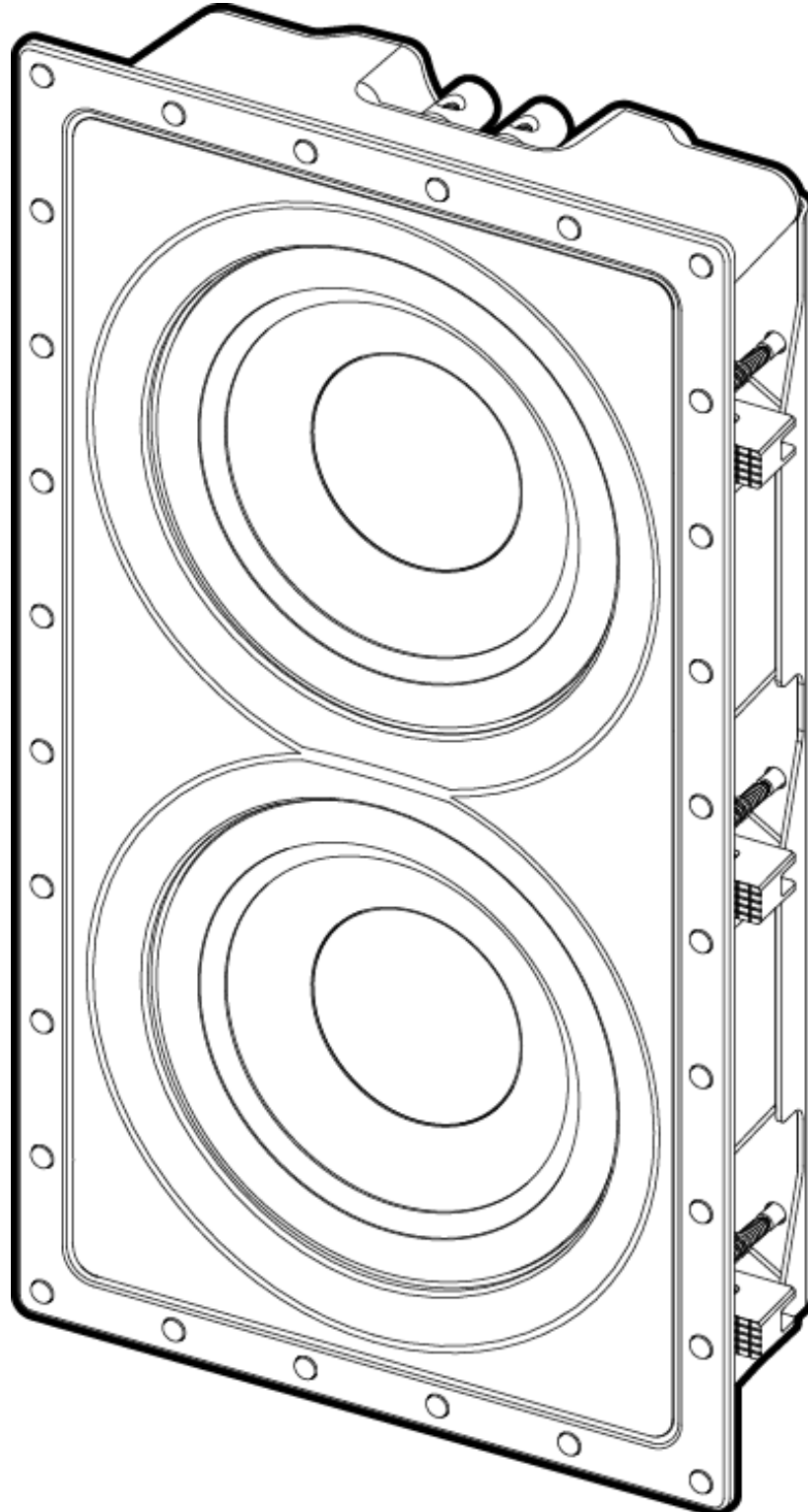

TABLE OF CONTENTS

1.0 SUBWOOFER ASSEMBLY PARTS LIST

2.0 YOUR NEW SUBWOOFER

3.0 THE LISTENING ROOM

4.0 GUIDELINES FOR DECIDING ON SUBWOOFER PLACEMENT

5.0 SUBWOOFER PLACEMENT

6.0 COLOR MATCH PAINTING

7.0 IN-WALL CAVITY PREPARATION

7.0 WIRING CONNECTIONS

8.0 SUBWOOFER INSTALLATION

LIMITED WARRANTY

1.0 SUBWOOFER ASSEMBLY PARTS LIST

- 1 subwoofer
- 1 subwoofer grille
- 1 mounting template

2.0 YOUR NEW SUBWOOFER

Break-In

Allow your Paradigm® subwoofer system to operate for several hours before you listen critically.

Cleaning

Clean subwoofer housing with a soft, damp cloth. Do not use a strong or abrasive cleaner or get any part of the subwoofer wet.

If you wish to paint your subwoofer grille, you must do so before installing it. See the section on "Color Match Painting" for full details.

3.0 THE LISTENING ROOM

Paradigm® in-wall subwoofers are suitable for use in a wide variety of listening environments. Note however, that room construction, dimensions and furnishings all play a part in the quality of sound you ultimately achieve. Try to follow these guidelines:

1. Strong, rigid walls are preferred for best bass balance. For even better results we recommend adding additional bracing and acoustic damping material to the cavity prior to installation. See section on "Subwoofer Installation" later in this manual for more details.
2. It is important to note that just as the amount of soft furnishings has a decided impact on mid and high frequencies, those frequencies below 150 Hz are dramatically affected by the room itself—its size, shape, as well as the physical boundaries of the room.

4.0 GUIDELINES FOR DECIDING ON SUBWOOFER PLACEMENT

When considering subwoofer placement directly into a wall, keep the following in mind:

- **DO NOT** install subwoofers in a ceiling.
- **DO NOT** install subwoofers into lath or plaster—over time, the bass vibrations will cause material to crack;
- **DO NOT** install subwoofers into cavities that contain ductwork;
- **DO NOT** locate subwoofers close to wall mounted fixtures that may vibrate (remember to check the other side of the wall too!);
- If installing in a wall with metal studs, make sure studs are securely fastened so that they do not vibrate or rattle;
- Some acoustic bleed-through into the adjacent room is unavoidable. See section on “**In-Wall Cavity Preparation**” for suggestions to reduce bleed-through.

5.0 SUBWOOFER PLACEMENT

Paradigm® in-wall subwoofers are designed to be used in pairs. Using a pair of subwoofers will allow you to randomize the standing waves within your listening room so that bass is distributed in a more uniform manner. Two subwoofers also ensures even lower distortion, especially at high output levels.

Bass is less and less directional as it goes down in frequency. For best sonic integration, placing one subwoofer in the wall at the front of the room and the other in the wall or at the rear usually provides the best performance and sonic integration. If this location is not possible, keeping in mind the guidelines provided earlier, you may place your subwoofers anywhere in the wall without affecting the stereo image of your front speakers or the soundstage of your multichannel speaker system.

Figs. 1a and 1b highlight how bass output is generally affected by in-wall and placement. When seated in the typical listening area of your room, placing the subwoofers in the various positions will typically result in bass performance as follows:

Fig. 1a: Corner placement close to the floor provides the best balance of output and accuracy.

Fig. 1b: Placement anywhere along the walls close to the floor, but outside the “shaded” area will provide slightly reduced output, though still acceptable accuracy.

If desired, for further optimized bass performance and even greater output, you can install an additional pair of Paradigm® in-wall subwoofers. **Fig. 1c** provides recommended placement for four subwoofers.

Broken lines in figures represent alternate placement for a pair of subwoofers

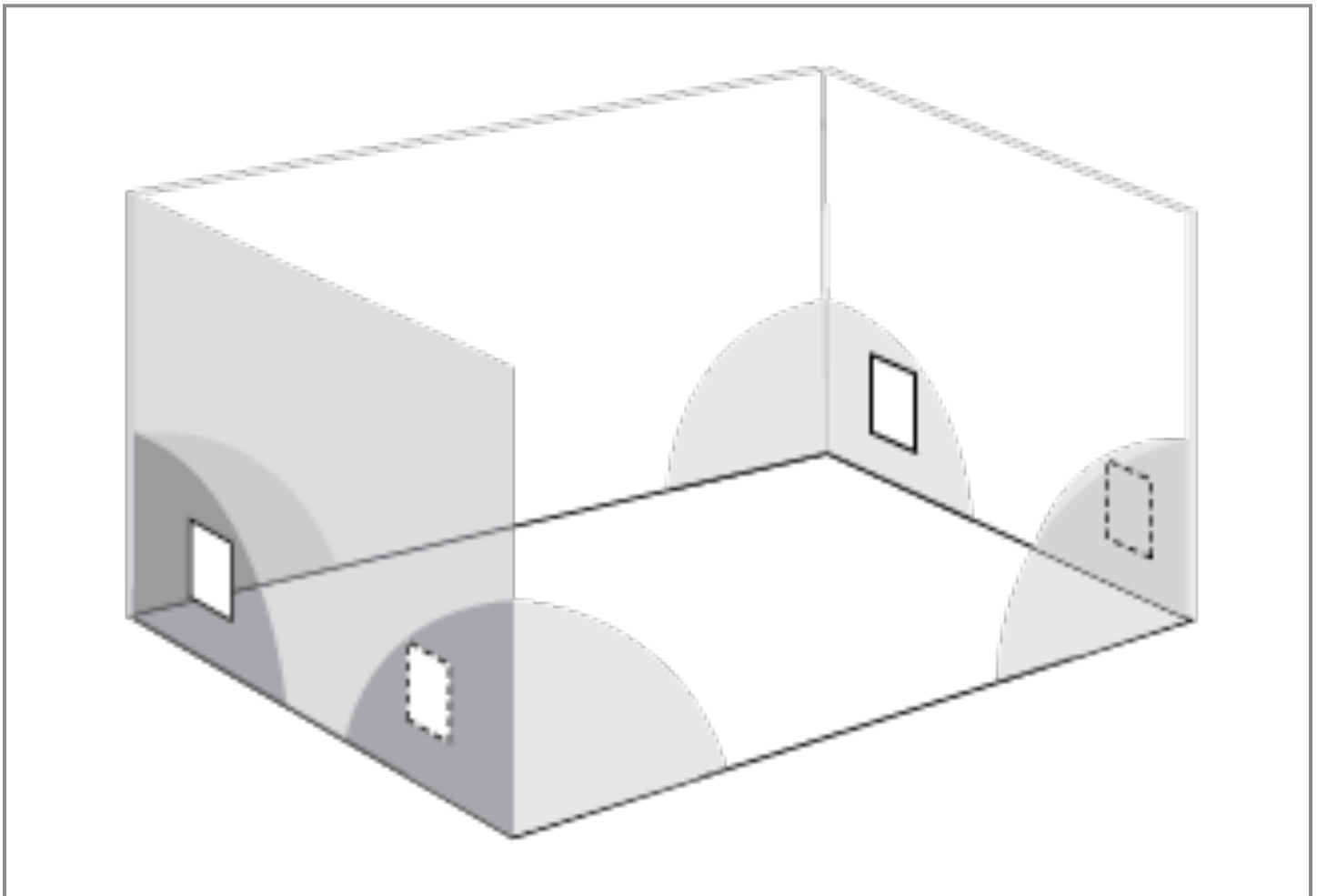

Fig. 1a Two subwoofers close to floor in corners of room

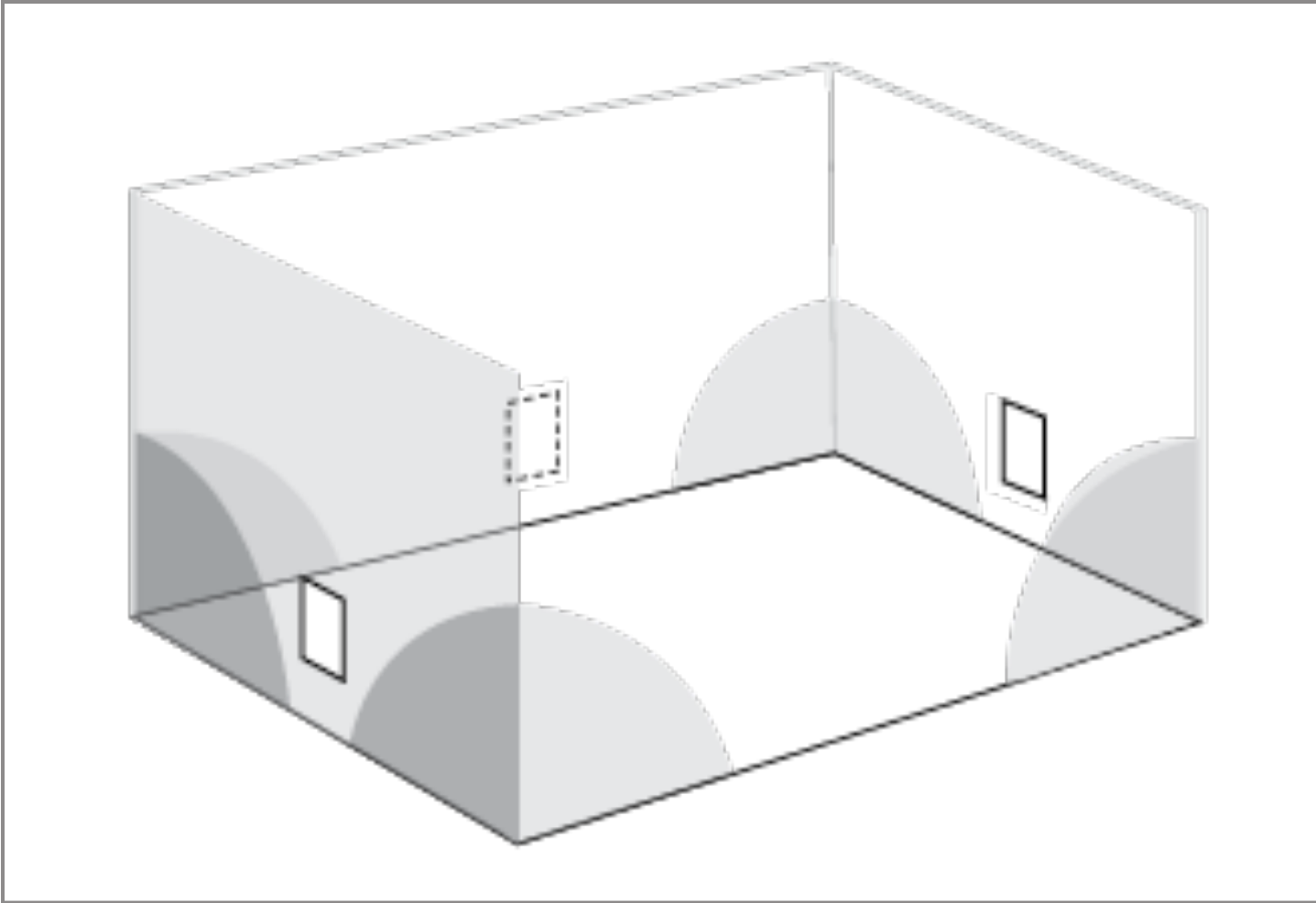

Fig. 1b Two subwoofers close to floor in middle of walls

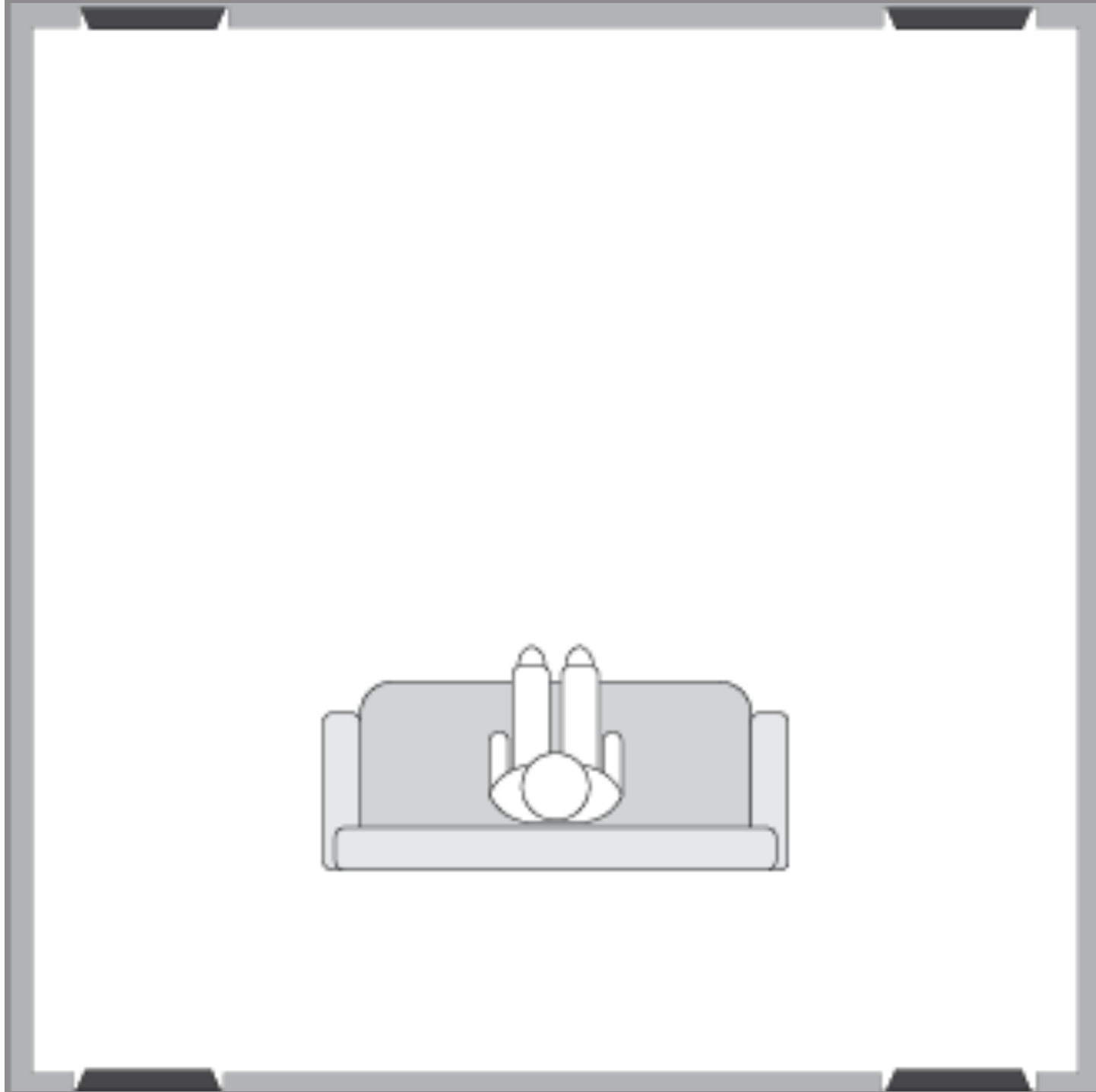

Fig. 1c Recommended placement for four subwoofers

6.0 COLOR MATCH PAINTING

The grille of your Paradigm In-Wall Subwoofer is finished in neutral white to blend into any room. However, the grilles may be painted to match any decor.

Please note:

- Do not paint the surface behind the grille • Do not use a paint roller or brush To Paint, Follow These Steps:

1. Remove the grille.
2. Remove the scrim. Set the scrim aside to install after the grille has dried.
3. In a well-ventilated area, spray a light coat of paint to the grille, letting the paint dry completely between coats. Always follow the paint manufacturer's directions.

TIP! Be careful to not plug the grille holes with paint. Do not paint the grilles when they are installed on the speaker.

7.0 IN-WALL CAVITY PREPARATION

STIFFENING AND STRENGTHENING THE CAVITY

Although Paradigm in-wall mounting systems are the most rigid on the market, when installing your subwoofer directly into a wall, to help avoid bass vibrations and minimize acoustic bleed-through, we recommend the following:

Additional Bracing

Additional cross-bracing will further stiffen the cavity. We suggest placing two to three pieces of 2" x 4" (more if application allows) within the cavity, evenly spaced above and below the cutout. Additional bracing can also be sandwiched to the studs/joists on either side of the subwoofer.

New Construction

New construction offers an excellent opportunity to strengthen and stiffen the cavity with additional bracing or construction-grade stiffening adhesives applied directly to the drywall. (See Dealer for more information).

- 1) Place the mounting template onto the wall. Use a level to make sure it's straight (Fig 2a).
- 2) Trace along the mounting template cut-out (Fig. 2b).

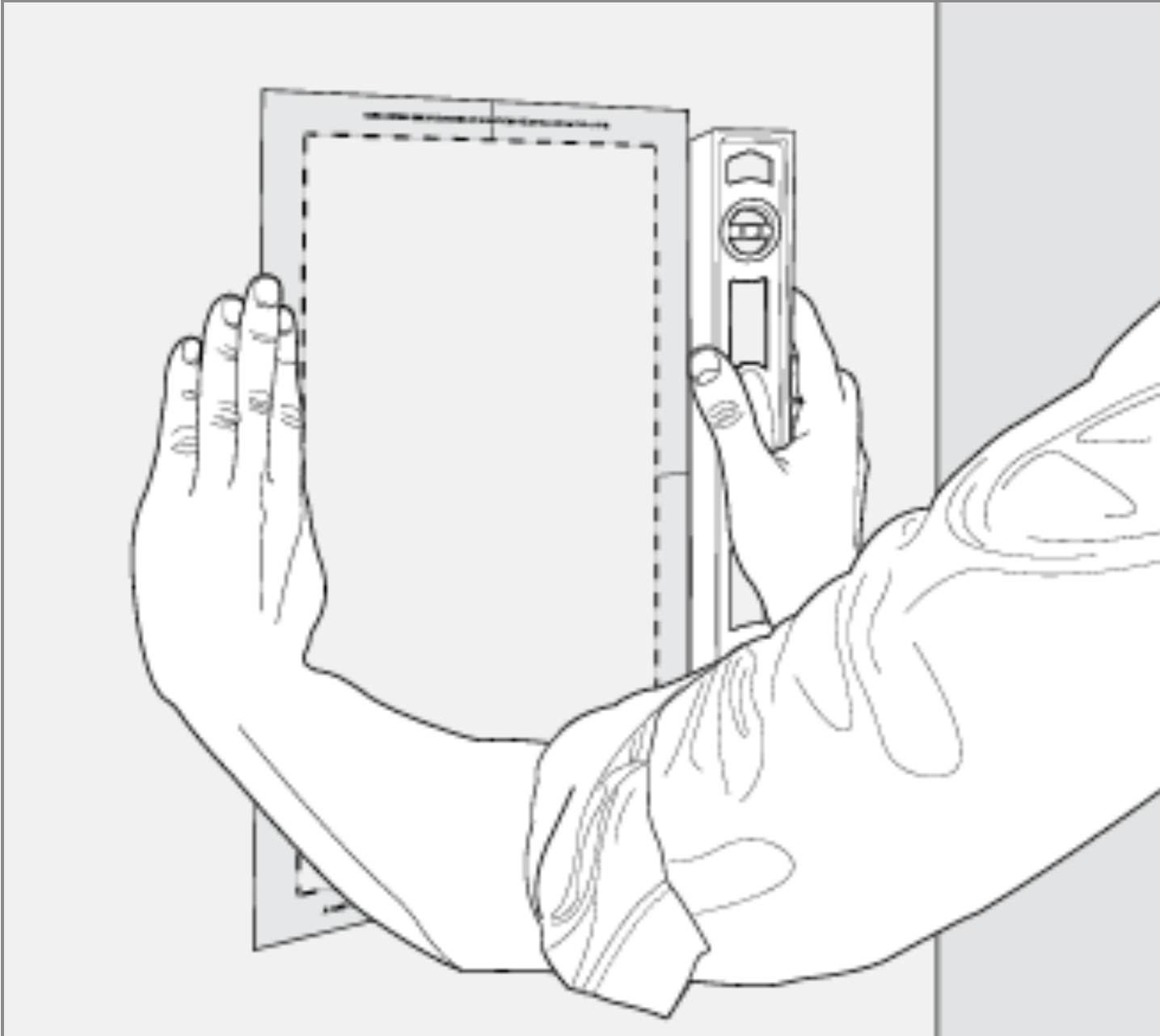

Fig. 2a

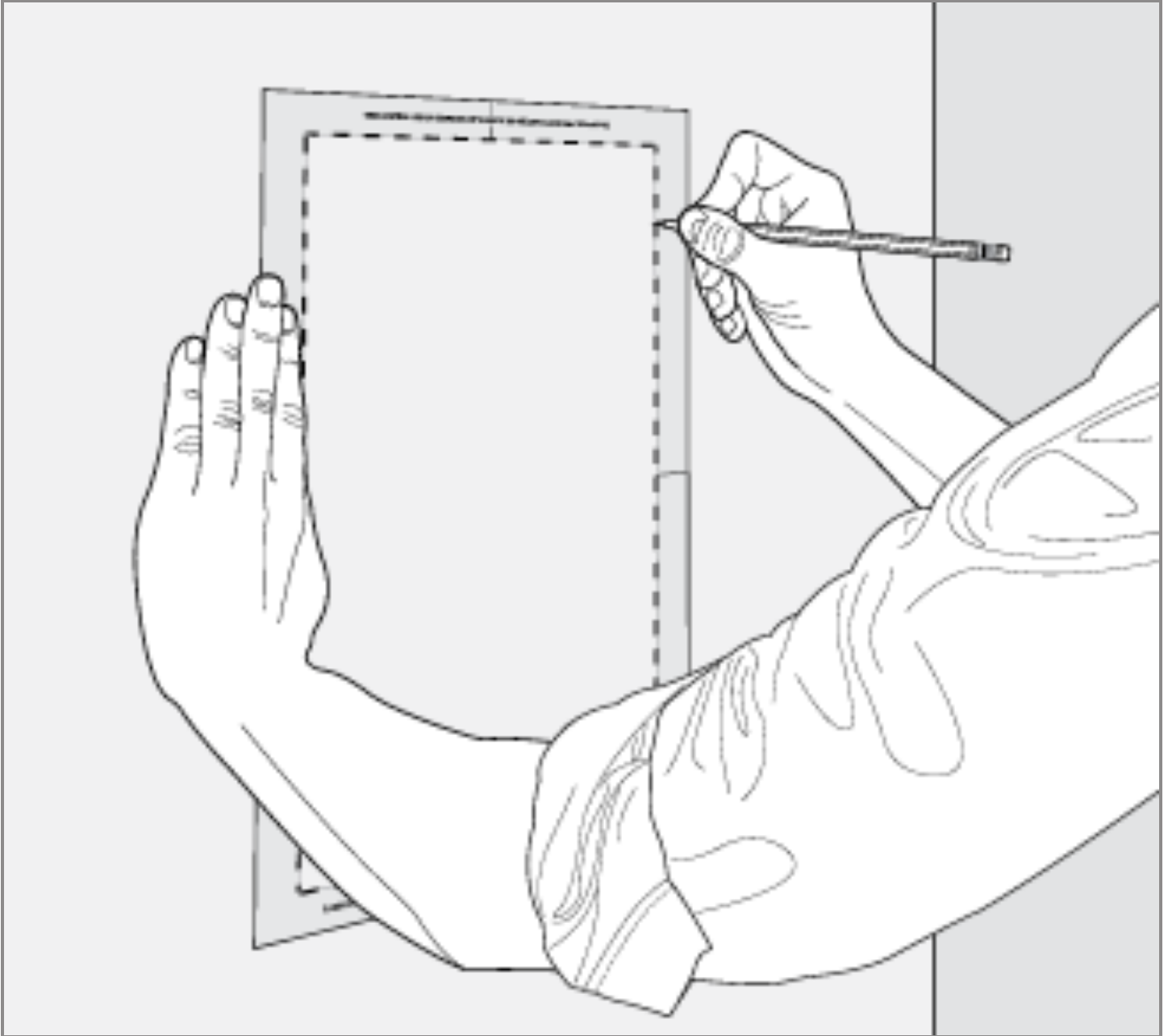

Fig. 2b

3) Cut a hole as indicated (Fig. 2c).

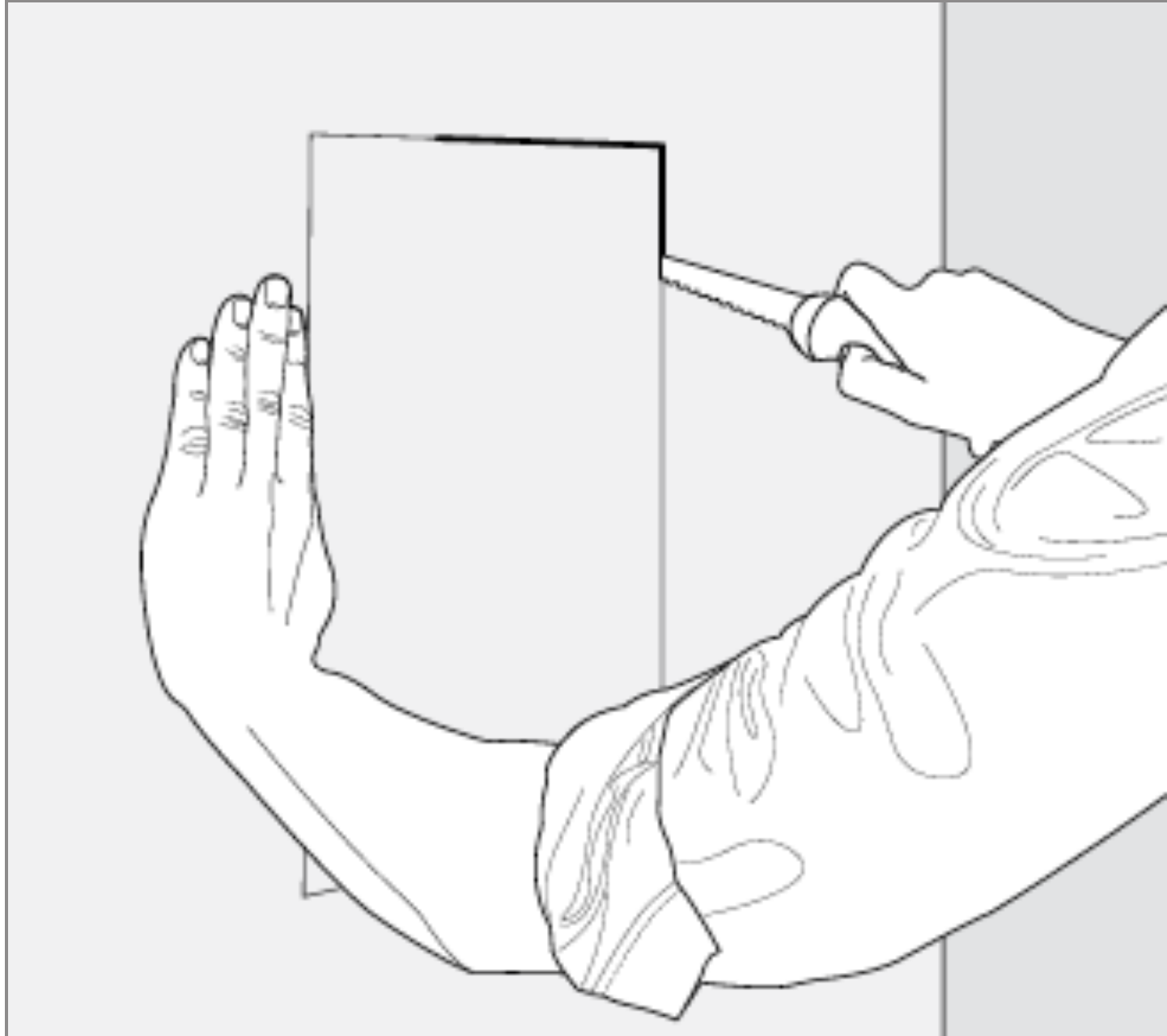

Fig. 2c

7.0 WIRING CONNECTIONS

The DCS-208FR3 presents a load that is compatible with 8 ohms. Please refer to your amplifiers Owner's Manual for it's specific capabilities and wiring instructions.

8.0 SUBWOOFER INSTALLATION

IMPORTANT! While it is possible to use a manual screwdriver for installation, we strongly suggest using a power drill. To avoid damaging or breaking the clamps, set your drill to a LOW setting. A high power setting is NOT necessary and may cause clamps to crack or break from the added force. Such damage is NOT covered under warranty.

- 1) Remove the magnetically attached baffle from the subwoofer assembly (Fig. 4a).
- 2) Set your Power Drill to the Low setting.
- 3) Gently position the assembly into the wall cavity (Fig. 4b).

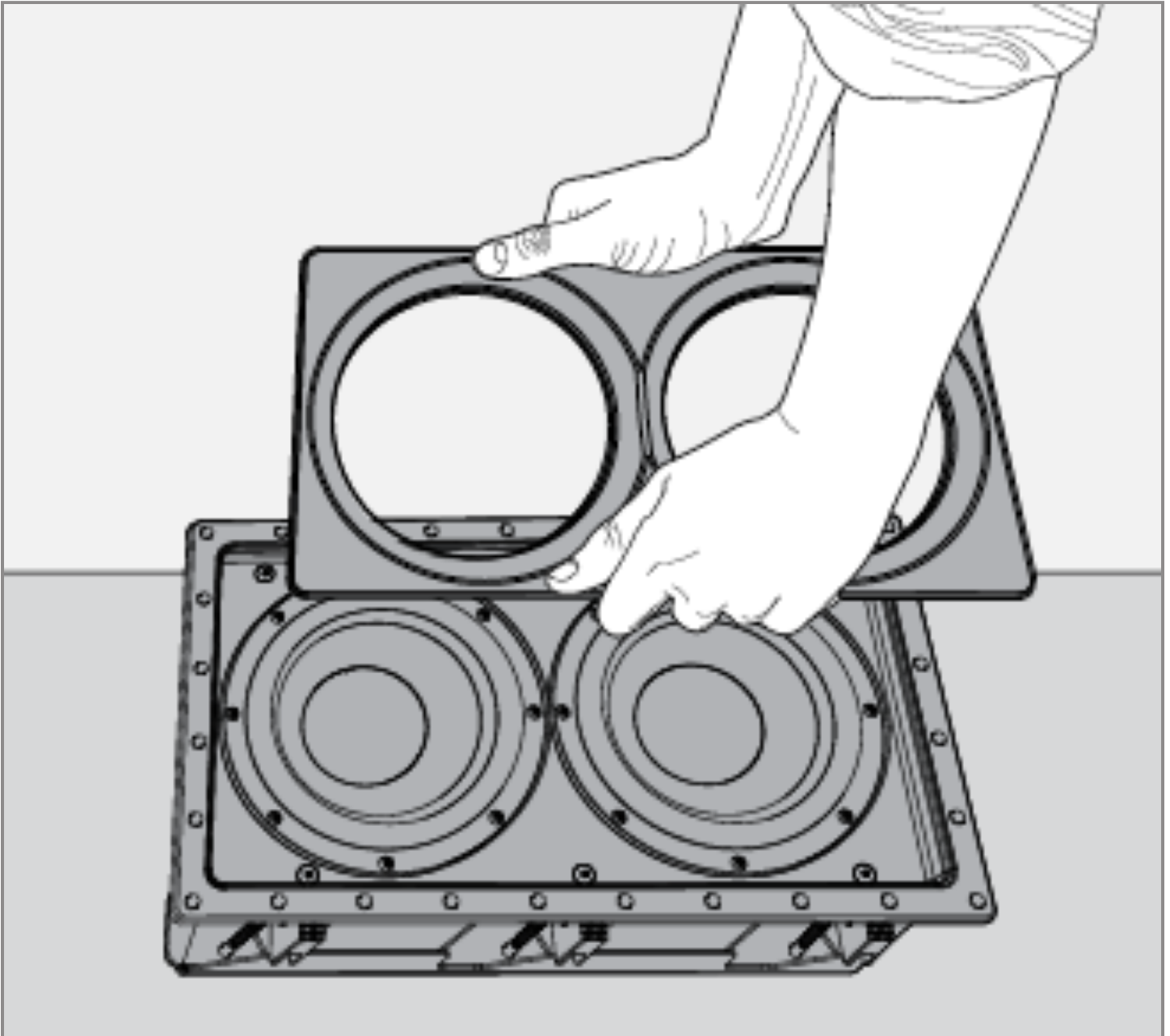

Fig. 4a

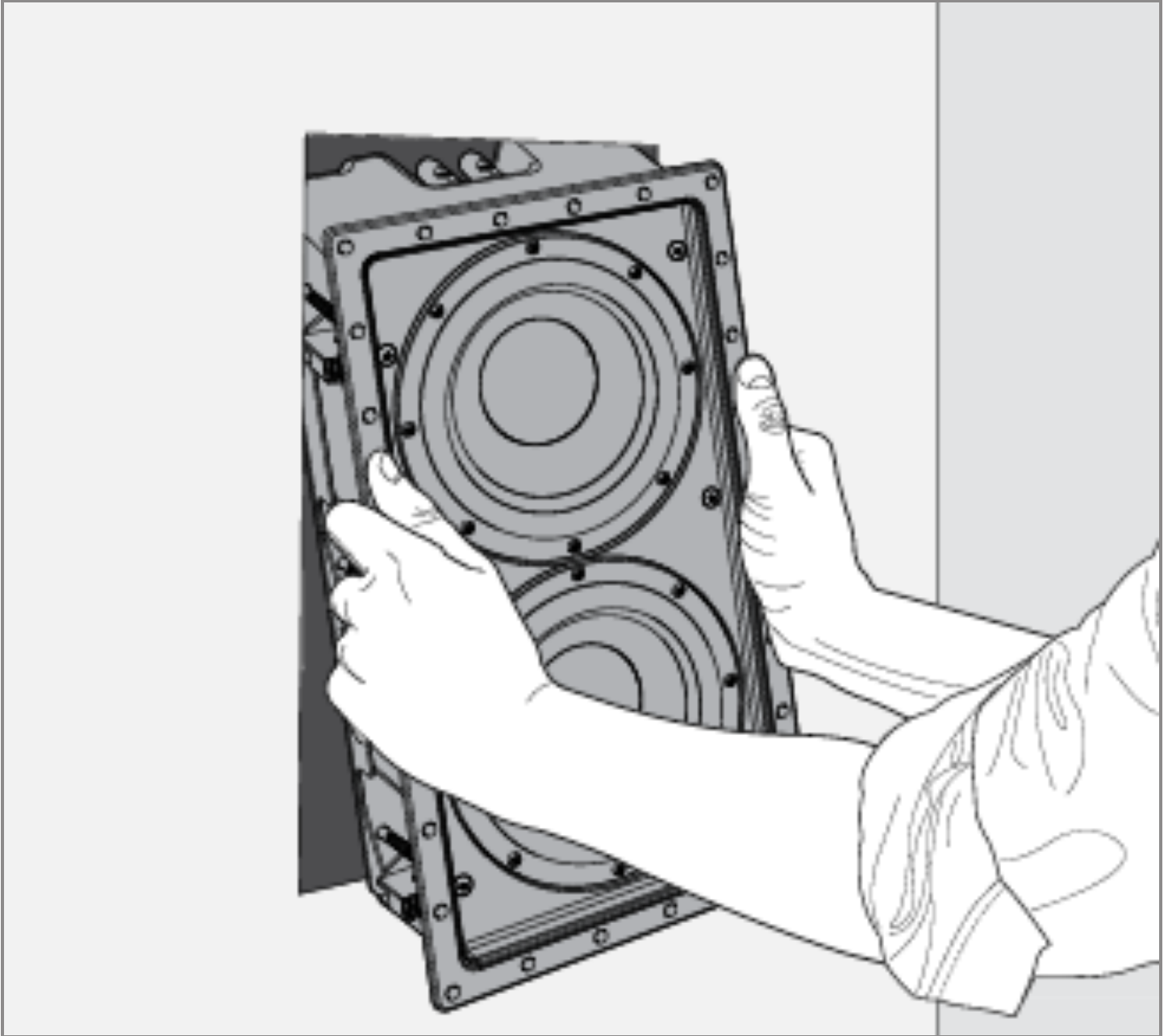

Fig. 4b

4) Supporting the assembly with one hand, tighten each screw (Fig. 4c). Stop tightening when you sense resistance. 5) Gently press the baffle onto the front face of the speaker (Fig. 4d). The magnets will ensure correct attachment.

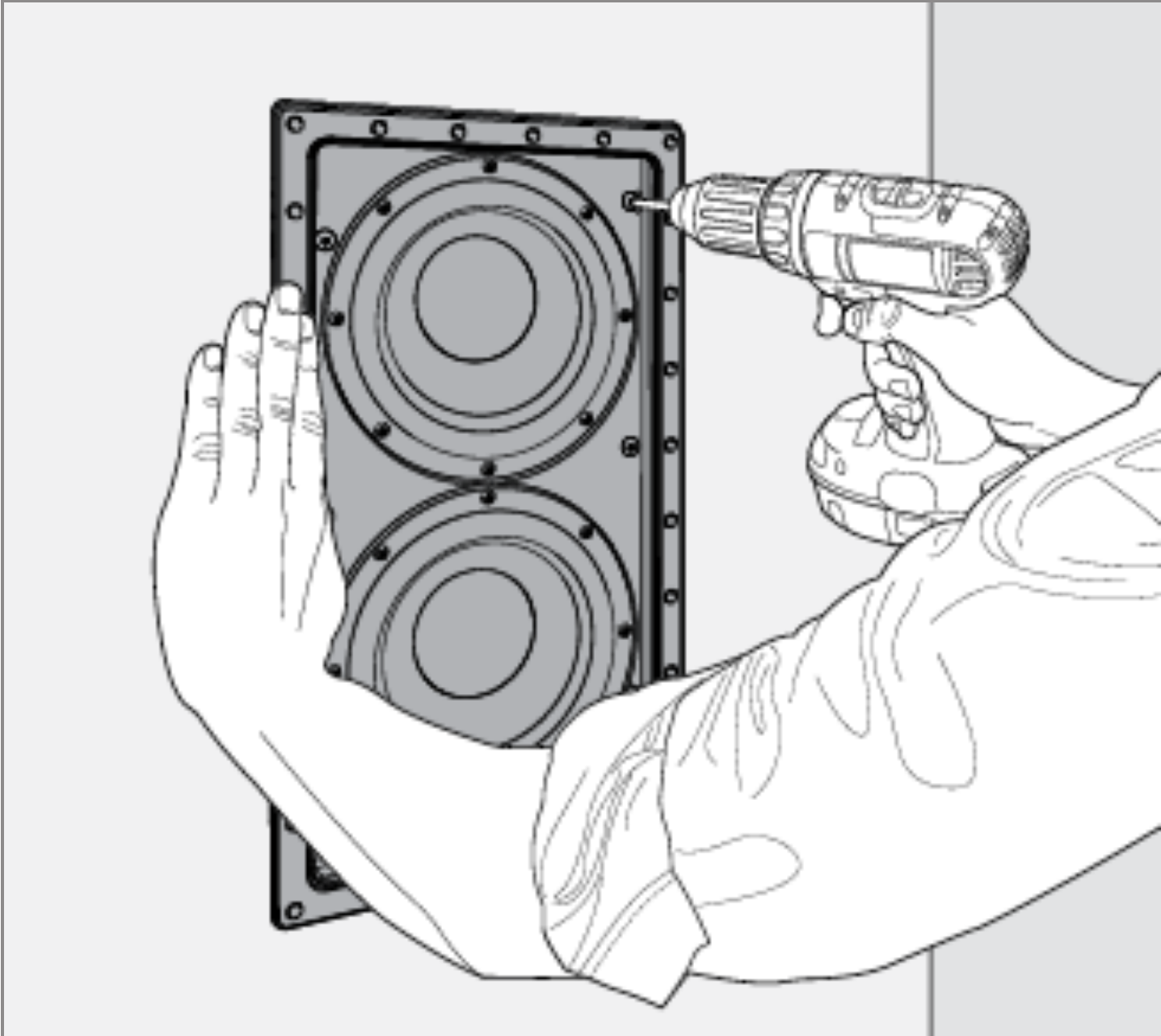

Fig.4c

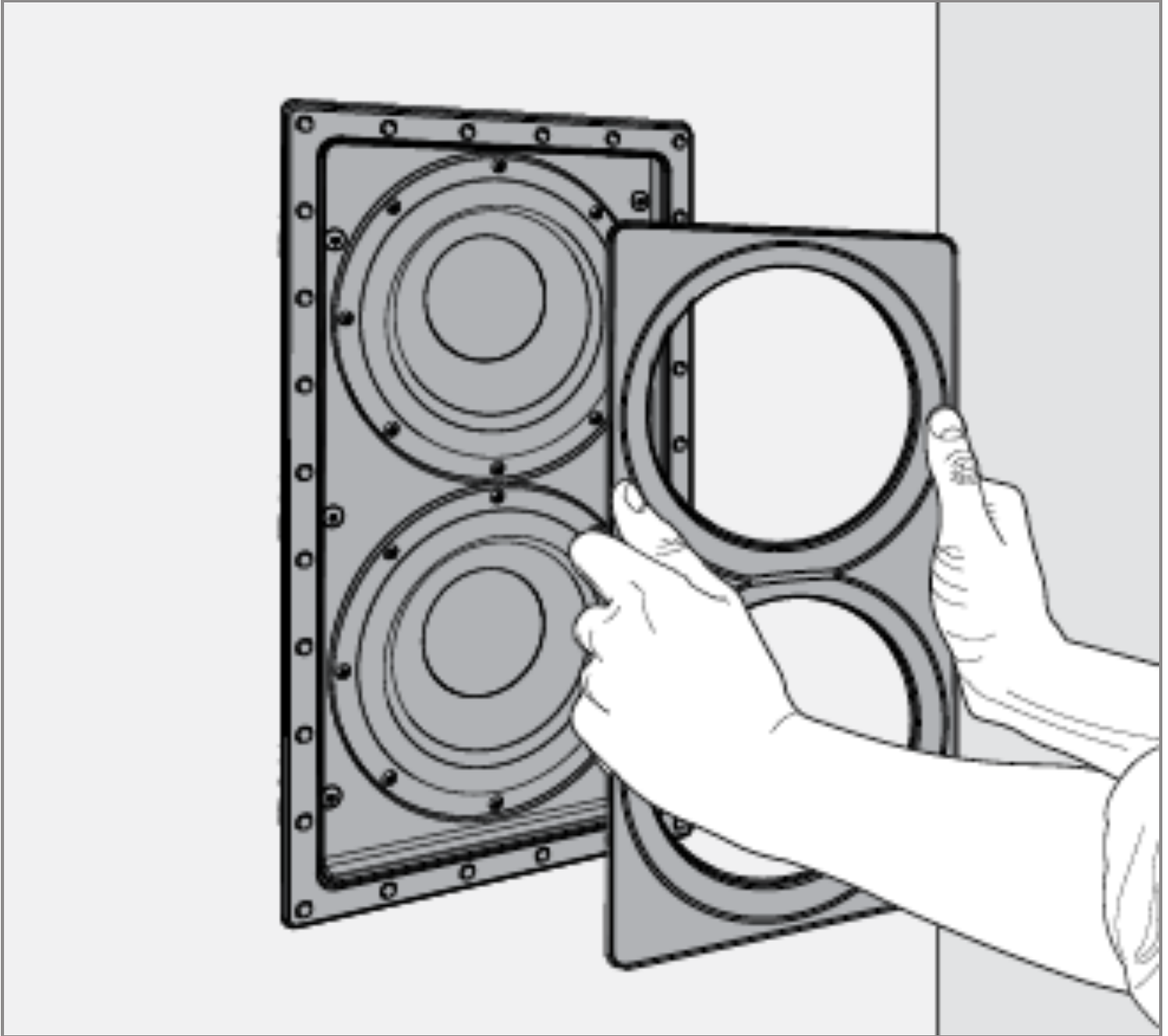

Fig. 4d

6) Gently press the grille onto the front face of the speaker (Fig. 4e). The magnets will ensure correct attachment.

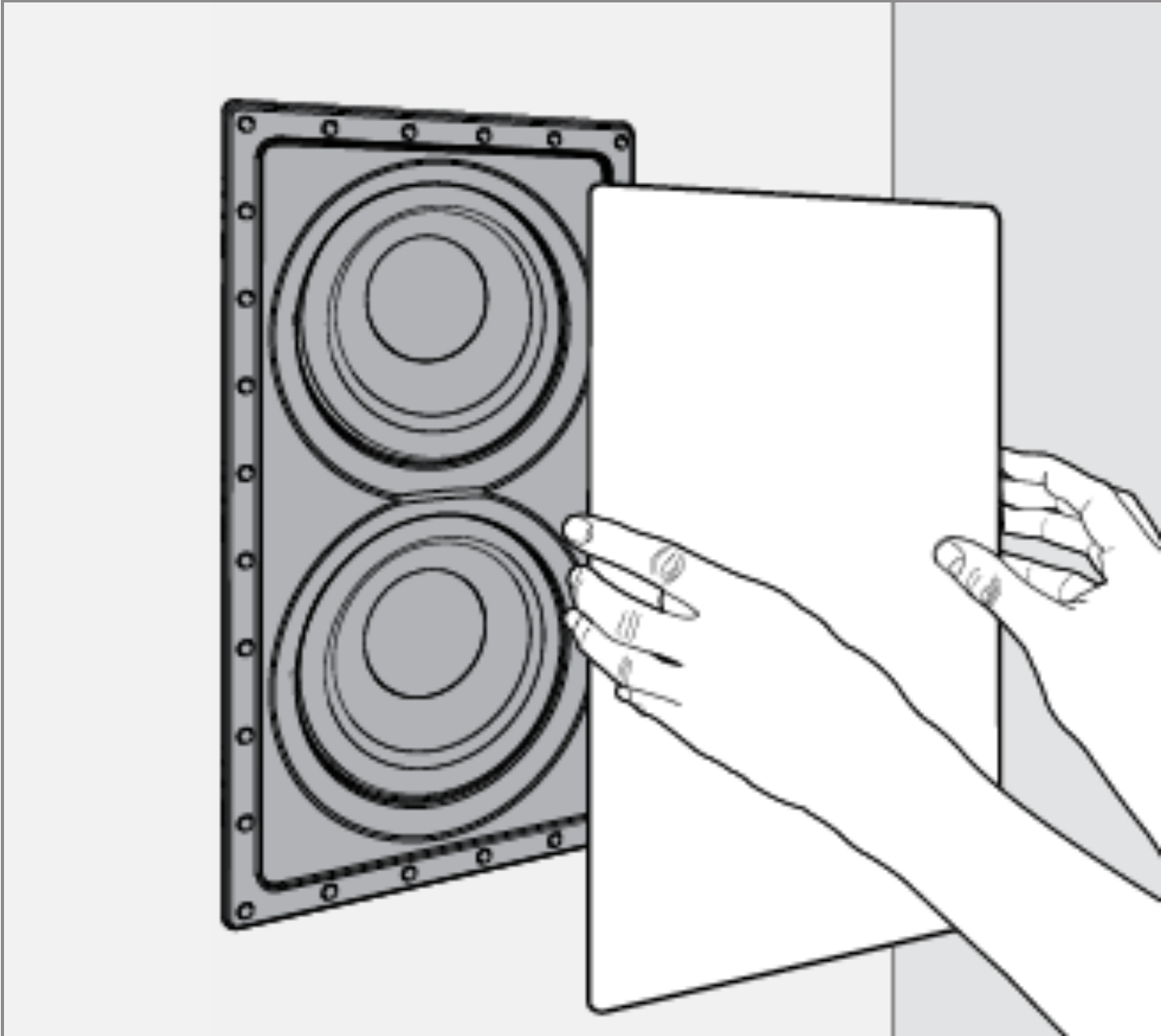

Fig. 4e

LIMITED WARRANTY

Paradigm® subwoofers covered in this manual are warranted to be and remain free of manufacturing and/or material defects for a period of three (3) years from the date of the original retail purchase.

Within the time period specified, repair, replacement or adjustment of parts for manufacturing and/or material defects will be free of charge to the original owner.

Thermal or mechanical abuse/misuse is not covered under warranty.

Limitations:

- Warranty begins on date of original retail purchase from an Authorized Paradigm® Dealer only. It is not transferable;
- Warranty applies to product in normal home use only. If the product is subjected to any of the conditions outlined in the next section, warranty is void;

Warranty is Void if:

- The product has been abused (intentionally or accidentally);
- The product has been used in conjunction with unsuitable or faulty equipment;
- The product has been subjected to damaging signals, derangement in transport, mechanical damage or any abnormal conditions;
- The product has been tampered with or damaged by an unauthorized service facility;
- The serial number has been removed or defaced.

Owner Responsibilities:

- Provide normal/reasonable operating care and maintenance;
- Provide or pay for transportation charges for product to service facility;
- Provide proof of purchase (your sales receipt given at time of purchase from your Authorized Paradigm® Dealer).

Should servicing be required, contact your nearest Authorized Paradigm® Dealer, Paradigm® Electronics Inc., or Import Distributor (outside the U.S. and Canada) to arrange, bring in or ship prepaid any defective unit.

Visit our website at www.paradigm.com for more information.

Paradigm Electronics Inc. reserves the right to improve the design of any product without assuming any obligation to modify any product previously manufactured.

This warranty is in lieu of all other warranties expressed or implied, of merchantability, fitness for any particular purpose and may not be extended or enlarged by anyone. In no event shall Paradigm Electronics Inc., their agents, or representatives be responsible for any incidental or consequential damages. Some jurisdictions do not allow limitation of incidental or consequential damages, so this exclusion may not apply to you.

Retain this manual and your sales receipt for proof of warranty term and proof of purchase.

